



FLUID-APPLIED SOLUTIONS



The Leader in Fluid-Applied Roof Restoration
System & Product Guide



THE LEADER IN FLUID-APPLIED ROOF RESTORATION

Founded in Mobile, Alabama in 2004, American WeatherStar is an established leader in the roof restoration industry. We are a manufacturer and supplier of high-quality, energy-efficient roof coating systems and products designed to restore and protect a variety of commercial and industrial roof substrates.

American WeatherStar systems are proven to stop leaks, reduce maintenance and energy costs, extend roof life, and cost half as much as a conventional roof replacement. We work closely with our Approved Contractors to ensure the highest-quality workmanship, exceptional service, and lasting results. We offer a complete line of high-performance, energy-efficient roof coatings, sealants, primers, cleaners, accessories, and roof maintenance and repair products.

This guide to American WeatherStar systems and products is designed to help our Approved Contractors better understand the many versatile and high-quality roofing solutions that we provide. For more information on American WeatherStar fluid-applied roof restoration systems and products, visit americanweatherstar.com.

I. SYSTEMS

Ure-A-Sil.....	3
Envir-O-Sil	4
Met-A-Gard	5
Met-A-Gard+	6
Met-A-Sil	7
Foam-Gard.....	8
Color-Gard	9
Color-Gard+	10
Wall-Coat.....	11
Wall-Coat DTM	12
StarGard Warranty	13

II. ROOF COATINGS

Acrylic 211	14
High-Tensile Acrylic 211	15
High-Build Acrylic 212	15
High-Gloss Acrylic 215	16
Acrylic Skylight Sealer 230	16
Butyl 310	17
Silicone 410.....	17
High-Solids Silicone 412	18
Aliphatic Urethane 510	18
Aromatic Urethane 520	19

III. ROOF MASTICS

Acrylic Brush-Grade 220.....	20
Acrylic Butter-Grade 221	21
Acrylic Flashing-Grade 222	21
Butyl Brush-Grade 320	22
Silicone Brush-Grade 422.....	22
Urethane Brush-Grade 522	23

IV. TERMINATOR ROOF SEALANT

Terminator 622	24
----------------------	----

V. PRIMERS & CLEANERS

Acrylic Bonding Primer 905.....	25
Red Oxide Rust Prime 912.....	26
Color Prime 915	26
EcoCleaner 925	27
Fabric Bond 930.....	27
Clear Prime 9000.....	28

VI. WALL COATINGS

Acrylic Wall Coat 2000	29
Elastomeric Wall Coat 2100	30
DTM 3000	30

VII. ACCESSORIES

Silicone Walk Path 415	31
Walk Path Granules 1100.....	32
Polyester Fabric.....	32
Butyl Seam Tape.....	33
Micro Fibers 1000.....	33
Xylene & Mineral Spirits	33

VIII. COATINGS COLOR CHART

Standard, Premium, & Custom Colors	34
--	----

IX. APPROVALS

System Approvals	35
Product Approvals.....	36

Ure-A-Sil®

ROOF RESTORATION SYSTEM

SUITABLE SUBSTRATES

- Modified bitumen
- EPDM
- Single-ply
- Built-up
- Spray polyurethane foam
- Concrete

SYSTEM PRODUCTS

- Silicone 410
- High-Solids Silicone 412*
- Aromatic Urethane 520
- Urethane Brush-Grade 522
- Polyester Fabric

**High-solids silicone option*

WARRANTY TERM LENGTH

- 12 year*
- 15 year*
- 20 year*

**Material & NDL System warranties available*

URETHANE-SILICONE FLAT ROOF RESTORATION SYSTEM

The Ure-A-Sil roof restoration system is proven to renew and protect a variety of commercial flat roofing substrates. The Ure-A-Sil system combines a urethane base coat with a silicone top coat to achieve the ultimate level of performance, durability, UV stability, and protection against ponding water conditions.

Roof restoration with Ure-A-Sil costs half as much as a conventional roof replacement and is proven to drastically reduce energy costs by decreasing internal building temperatures. The Ure-A-Sil system provides superior protection against harsh UV rays, prolongs roof life, and helps prevent future degradation.

ADVANTAGES

Cold Weather: Colder temperatures have less effect on the materials that comprise this system, so the application time frame is increased.

Longer Warranty Lengths: The Ure-A-Sil system is eligible for a full system or material-only warranty option with 12-year, 15-year, and 20-year term lengths.

Low-Slope Roofs: With superior resistance to ponding water, the Ure-A-Sil system is ideally suited for low slope roofs with minimal/poor drainage.

Moisture Cure: This system is comprised of moisture-cure products suitable for use in areas with high probability of rain and/or cold temperatures.

LIMITATIONS

Produces Strong Odor: While not harmful, xylene-based products produce strong fumes that can be problematic to building tenants. To avoid this problem, ensure that all HVAC units are set to recirculate air from within the building.

- 1 Existing Roof Material**
- 2 Seams/Details:** Urethane Brush-Grade 522
- 3 Base Coat:** Aromatic Urethane 520
- 4 Top Coat:** Silicone 410/High-Solids Silicone 412

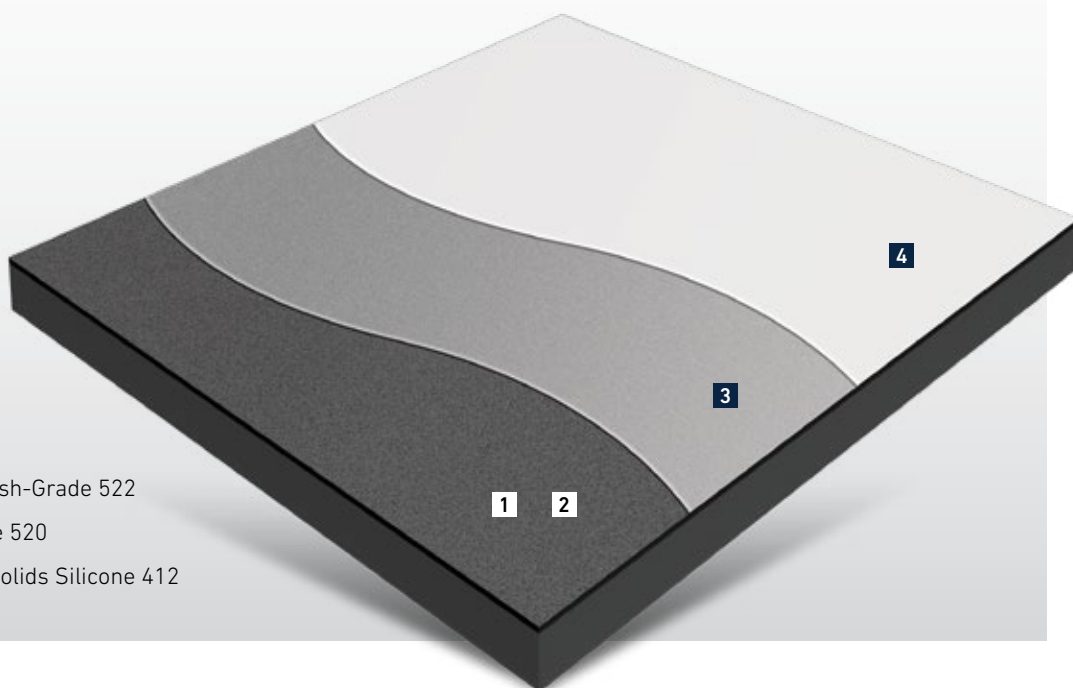

Envir-O-Sil™

ROOF RESTORATION SYSTEM

SUITABLE SUBSTRATES

- Modified bitumen
- EPDM
- Single-ply
- Built-up
- Spray polyurethane foam

SYSTEM PRODUCTS

- High Solids Silicone 412
- Terminator 622
- Silicone Brush-Grade 422
- Acrylic Bonding Primer 905
- Fabric Bond 930
- Polyester Fabric

WARRANTY TERM LENGTH

- 10 year*
- 15 year*
- 20 year*

**Material & NDL System warranties available*

LOW-VOC FLAT ROOF RESTORATION SYSTEM

The Envir-O-Sil roof restoration system is a low VOC option for coating commercial flat roofs. The system is designed around the proven performance and versatility of its core component, High Solids Silicone 412.

The Envir-O-Sil system is not only good for your business, it's safe for the environment. In areas where strict environmental regulations are a factor, the Envir-O-Sil system has been proven to be an environmentally-safe solution to restore and protect multiple types of commercial and industrial roof surfaces.

ADVANTAGES

Low VOC: The Envir-O-Sil system is a low VOC, environmentally safe solution ideally suited for areas that must adhere to strict environmental regulations.

Low Odor: Silicone-based coatings are low odor, unlike xylene-based coatings which produce strong fumes that can be problematic for building tenants.

Moisture-Cure: This system is comprised of moisture-cure products suitable for use in areas with high probability of rain and/or cold temperatures.

LIMITATIONS

Durability: All silicone systems are more susceptible to damage from severe weather, mechanical damage, and pedestrian traffic. If durability is a concern, consider our Ure-A-Sil system instead.

Adhesion: For certain roof types, a primer application may be required for silicone base coats to achieve maximum adhesion.

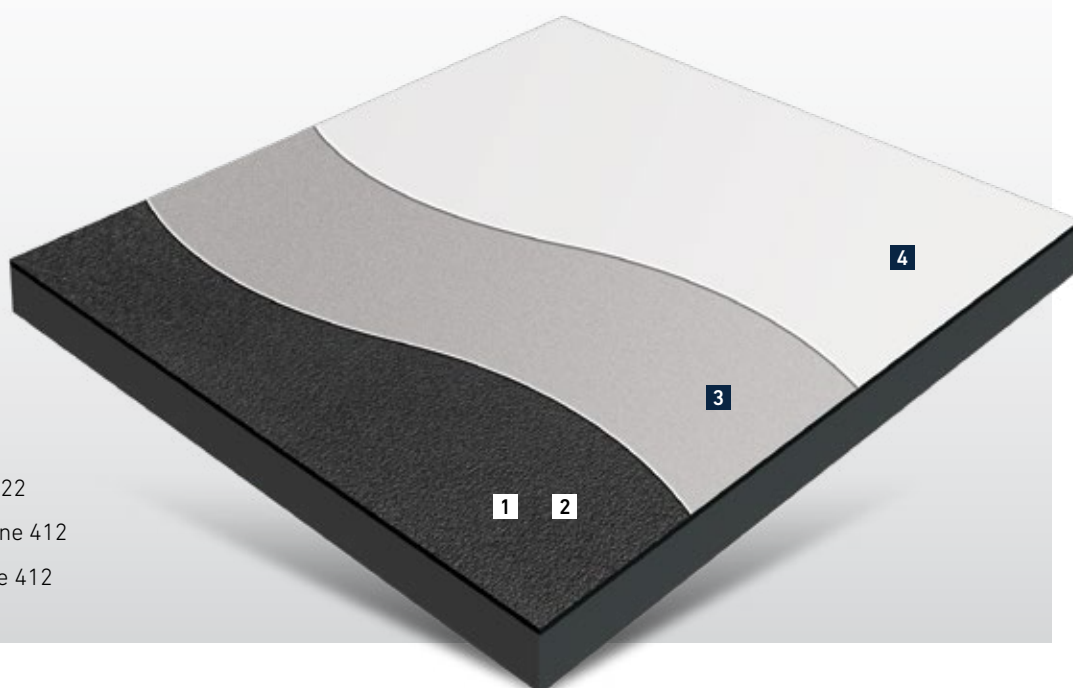

1 Existing Roof Material

2 Seams/Details: Terminator 622

3 Base Coat: High-Solids Silicone 412

4 Top Coat: High-Solids Silicone 412

Met-A-Gard™

ROOF RESTORATION SYSTEM

SUITABLE SUBSTRATES

- Metal

SYSTEM PRODUCTS

- Acrylic 211
- Acrylic Brush-Grade 220
- Acrylic Butter-Grade 221
- Red Oxide Rust Prime 912
- Polyester Fabric

WARRANTY TERM LENGTH

- 5 year*
- 10 year*

**Material & NDL System warranties available*

PREMIUM ACRYLIC METAL ROOF RESTORATION SYSTEM

The Met-A-Gard roof restoration system is proven to restore and protect commercial metal roofs from harsh external elements. This system sets the standard for quality and affordability in metal roof repair and restoration.

The Met-A-Gard system offers a bright white ENERGY STAR® rated finish backed with long-term material and system warranties. The system's main component is Acrylic 211, which provides superior durability, reflectivity, and mildew resistance. In addition, the elongation and tensile strength of Acrylic 211 increase in colder temperatures.

ADVANTAGES

Economical: Acrylic roof restoration systems are less expensive than most solvent-based solutions available on the market.

Warm/Dry Weather: Application in warm/dry weather conditions ensure the success of acrylic (water-based) systems.

LIMITATIONS

Cold Weather: The products that comprise this system are water-based, so colder temperatures can delay the installation process.

Precipitation: To avoid material wash off, this system should not be applied if rain is expected.

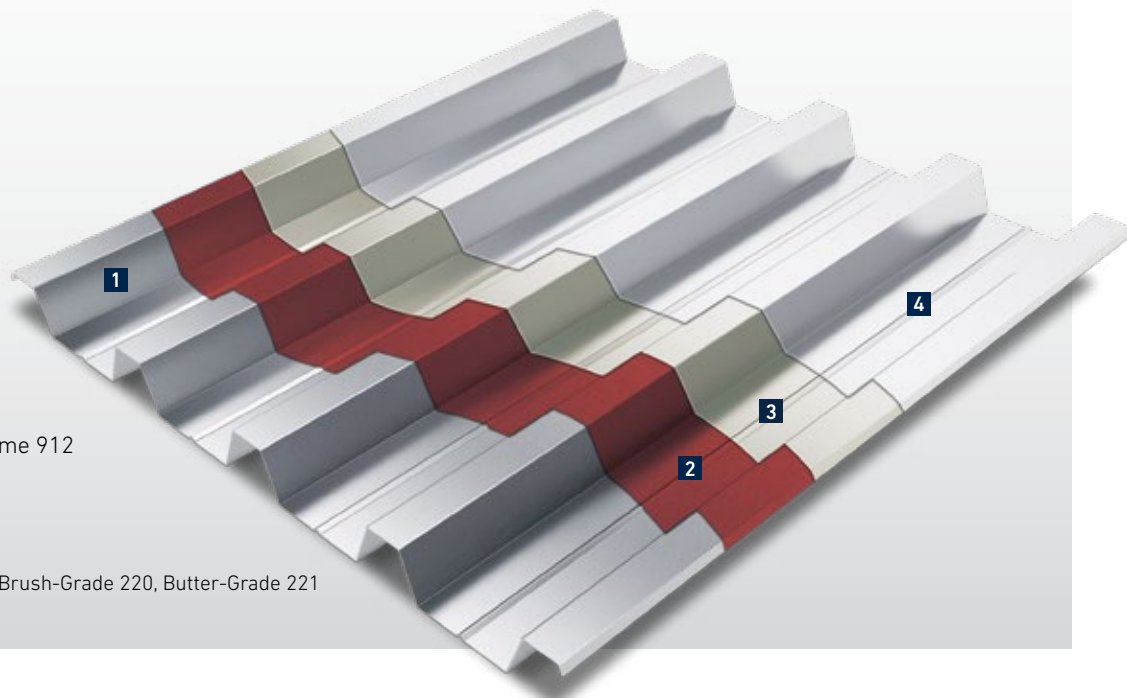

1 Existing Roof Material

2 Primer: Red Oxide Rust Prime 912

3 Base Coat: Acrylic 211

4 Top Coat: Acrylic 211

Seams/Fasteners/Details: Acrylic Brush-Grade 220, Butter-Grade 221

Met-A-Gard⁺

ROOF RESTORATION SYSTEM

SUITABLE SUBSTRATES

- Metal

SYSTEM PRODUCTS

- High-Tensile Acrylic 211
- Urethane Brush-Grade 522
- Red Oxide Rust Prime 912
- Polyester Fabric

WARRANTY TERM LENGTH

- 12 year*
- 15 year*
- 20 year*

**Material & NDL System warranties available*

HIGH-TENSILE ACRYLIC METAL ROOF RESTORATION SYSTEM

The Met-A-Gard+ roof restoration system is the ultimate solution in metal roof restoration. This system raises the bar with a technologically advanced high-tensile acrylic coating as its main component. The physical properties of this elastomeric coating make it the best choice for extreme climates and color retention.

The Met-A-Gard+ system provides a bright white, ENERGY STAR® rated finish backed with long-term Star-Gard Material and NDL System warranties. This system uses High-Tensile Acrylic 211 for superior elongation and tensile strength.

ADVANTAGES

Warm/Dry Weather: Applications during warm/dry weather conditions ensure the success of acrylic (water-based) systems.

Longer Warranty Lengths: The Met-A-Gard+ system is eligible for a full system or material-only warranty option with 12, 15, and 20-year term lengths.

Custom-Color Tints: Met-A-Gard+ utilizes High-Tensile Acrylic 211 which has superior color retention, making it ideal for custom color roof restoration projects.

LIMITATIONS

Cold Weather: The products that comprise this system are water-based, so colder temperatures can delay the installation process.

Precipitation: To avoid material wash off, this system should not be applied if rain is expected.

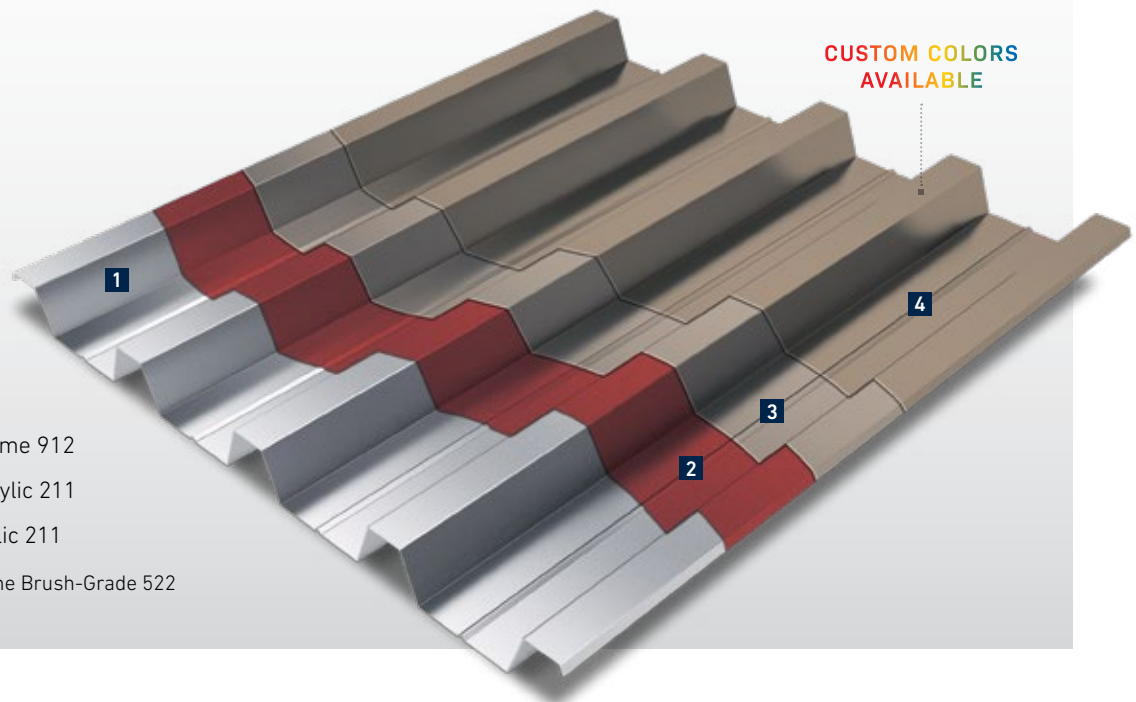

1 Existing Roof Material

2 Primer: Red Oxide Rust Prime 912

3 Base Coat: High-Tensile Acrylic 211

4 Top Coat: High-Tensile Acrylic 211

Seams/Fasteners/Details: Urethane Brush-Grade 522

Met-A-Sil™

ROOF RESTORATION SYSTEM

SUITABLE SUBSTRATES

- Metal

SYSTEM PRODUCTS

- Silicone 410
- High Solids Silicone 412*
- Silicone Brush-Grade 422*
- Urethane Brush-Grade 522
- Red Oxide Rust Prime 912
- Polyester Fabric

**High-solids silicone option*

WARRANTY TERM LENGTH

- 12 year*
- 15 year*
- 20 year*

**Material & NDL System warranties available*

PREMIUM SILICONE METAL ROOF RESTORATION SYSTEM

The Met-A-Sil roof coating system is a silicone-based system designed to restore and protect metal roofs. This system provides a bright white ENERGY STAR® rated finish based on the performance of its primary component: Silicone 410.

The Met-A-Sil system's Silicone 410 top coat offers the highest level of UV stability and water resistance available in the industry. This system forms a highly reflective, seamless, water-tight membrane that is proven to stop leaks and prevent rust.

ADVANTAGES

Longer Term Lengths: This system is available with full system or material-only warranty options with 12, 15, and 20-year term lengths.

Cold Weather: Colder temperatures have less effect on the materials that comprise this system, so the application time frame is increased.

Precipitation: This system is comprised of moisture-cure products suitable for application in areas with high probability of rain.

LIMITATIONS

Extremely Slippery: Silicone-coated metal roof surfaces are slippery when moisture is present. If pedestrian traffic is expected, consider using roofing granules to provide a durable, non-slip surface.

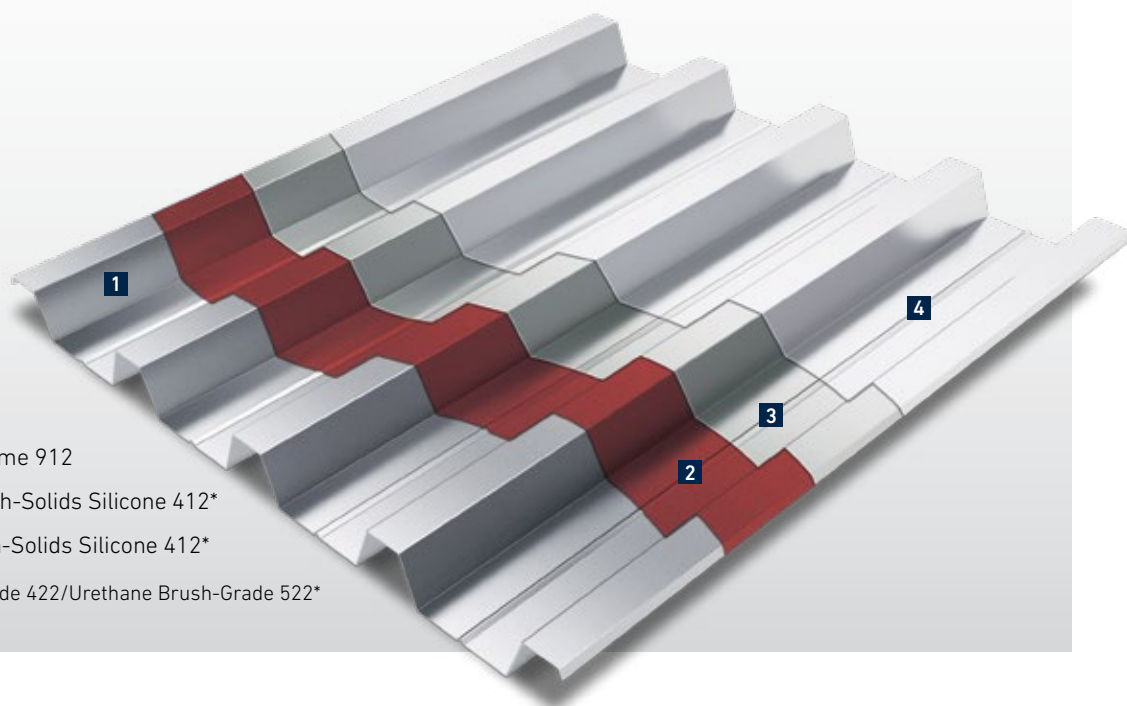

1 Existing Roof Material

2 Primer: Red Oxide Rust Prime 912

3 Base Coat: Silicone 410/High-Solids Silicone 412*

4 Top Coat: Silicone 410/High-Solids Silicone 412*

Seams/Details: Silicone Brush-Grade 422/Urethane Brush-Grade 522*

Foam-Gard™

SPF + ROOF COATING SYSTEM

SUITABLE SUBSTRATES

- Metal
- Modified bitumen
- Built-up
- Single-ply
- Concrete

SYSTEM PRODUCTS

- Acrylic 211
- High-Tensile Acrylic 211
- Silicone 410
- High Solids Silicone 412
- Aliphatic Urethane 510
- Aromatic Urethane 520
- Spray Polyurethane Foam (2.5-3.0 lb density)

WARRANTY TERM LENGTH

- 10 year*
- 12 year*
- 15 year*
- 20 year*

*Material & NDL System warranties available

HIGH-PERFORMANCE SPF + ROOF COATING SYSTEM

Foam-Gard is a spray polyurethane foam (SPF) roofing system designed to waterproof roofs and save on energy costs. Buildings with SPF systems typically insulate up to 50% better than those with other traditional roofing systems.

The Foam-Gard system features various top coat options, making it one of the most versatile solutions available for commercial and industrial roof surfaces. Top-coating SPF with a highly reflective fluid-applied roof coating provides the ultimate level of energy efficiency, climate control, and elemental protection.

ADVANTAGES

Superior Insulation: SPF systems have insulative properties that drastically reduce energy consumption and improve interior temperatures.

Superior Strength: SPF systems increase structural integrity and withstand the effects of thermal movement (normal expansion and contraction) in roof surfaces.

Versatility: Depending on the roof type, the Foam-Gard system utilizes an acrylic, silicone, or urethane top coat to protect the SPF foundation from the elements.

LIMITATIONS

Application Equipment: The installation equipment is expensive and requires a high degree of technical knowledge and experience.

Cost: Coated SPF systems generally cost more than other types of coating systems.

Cold Weather: Colder temperatures can delay the installation process.

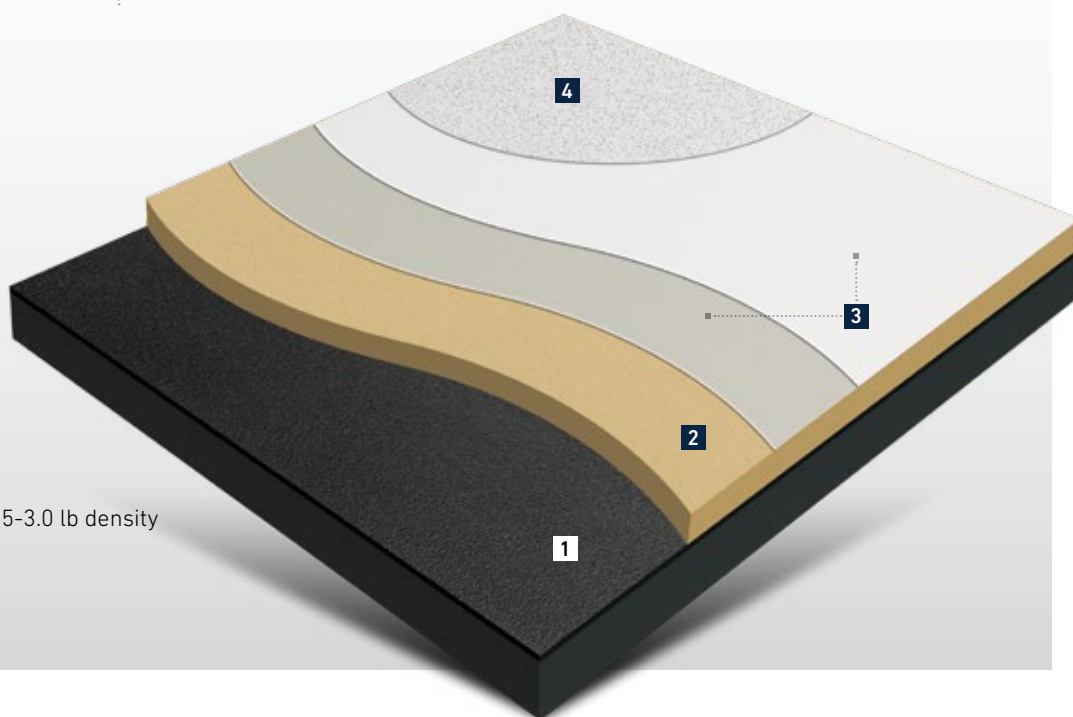

- 1 Existing Roof Material
- 2 Spray Polyurethane Foam: 2.5-3.0 lb density
- 3 Roof Coating Application(s)
- 4 Roofing Granules

Color-Gard™

ARCHITECTURAL ROOF COATING SYSTEM

SUITABLE SUBSTRATES

- Metal

SYSTEM PRODUCTS

- High-Gloss Acrylic 215
- Red Oxide Rust Prime 912
- Color Prime 915

WARRANTY TERM LENGTH

- 10 year (*Color Fade Warranty*)
- 10 year (*Material Only*)

ARCHITECTURAL METAL ROOF COATING SYSTEM

The Color-Gard Architectural Roof Coating System combines our innovative Color Prime 915 and High-Gloss Acrylic 215 to create a brilliant finish with superior color-fade resistance. This highly-advanced coating system provides commercial metal roof surfaces with a beautiful, low-build, architectural finish and contributes unsurpassed reflectivity, weatherability, abrasion-resistance, colorfastness, and resistance to dirt pick-up.

ADVANTAGES

Produces Aesthetic Finish: This highly-advanced coating system provides aged metal roof surfaces with a beautiful, low-build, architectural finish.

Custom Colors: The products that comprise this system are developed with superior color retention.

Low VOC: This system is a low VOC environmentally safe solution ideally suited for areas with strict environmental regulations.

Color Fade Warranty: This system includes a 10 year color fade warranty.

LIMITATIONS

Cost: This system costs more than other conventional metal roof coating systems.

Cold Weather: The products that comprise this system are water-based, so colder temperatures can delay the installation process.

Precipitation: To avoid material wash off, this system should not be applied if rain is expected.

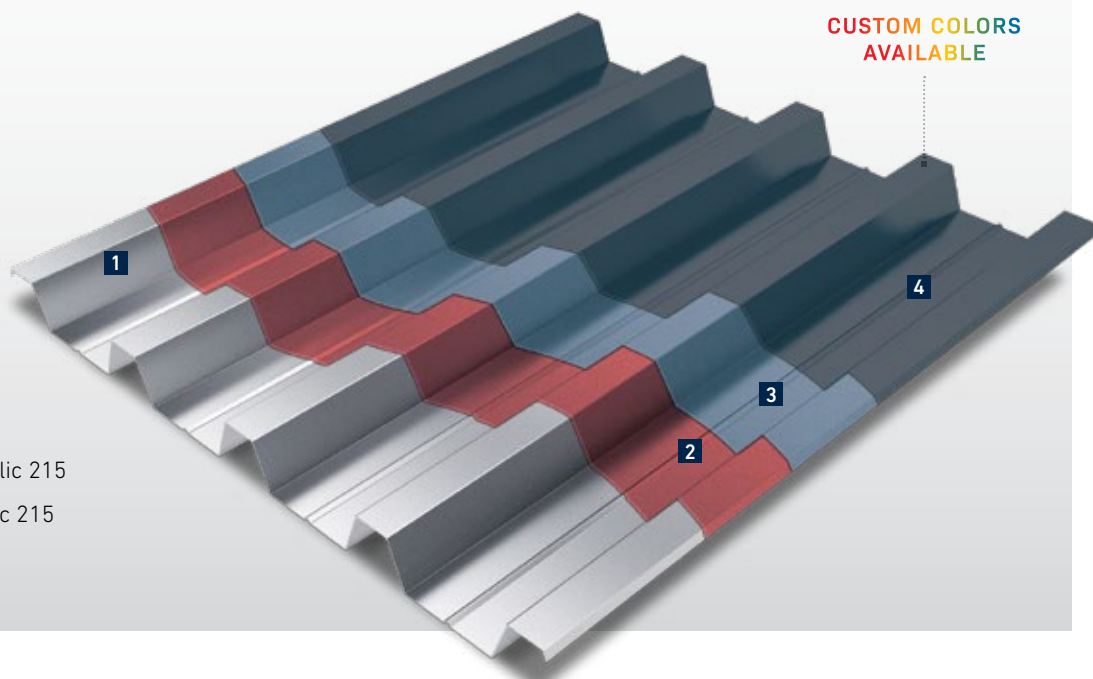

- 1 Existing Roof Material**
- 2 Primer:** Color Prime 915
- 3 Base Coat:** High-Gloss Acrylic 215
- 4 Top Coat:** High-Gloss Acrylic 215

Color-Gard⁺

ARCHITECTURAL ROOF COATING SYSTEM

SUITABLE SUBSTRATES

- Metal

SYSTEM PRODUCTS

- High-Tensile Acrylic 211
- High-Gloss Acrylic 215
- Red Oxide Rust Prime 912
- Terminator 622

WARRANTY TERM LENGTH

- 10 year (*Color Fade Warranty*)
- 12 year*
- 15 year*
- 20 year*

**Material & NDL System warranties available*

ARCHITECTURAL METAL ROOF COATING SYSTEM

The Color-Gard+ Architectural Roof Coating System combines our innovative High-Gloss Acrylic 215 with the superior elongation, tensile strength, and color retention of High-Tensile Acrylic 211. This highly-advanced coating system provides metal roof surfaces with a beautiful, water-tight, high-build, architectural finish and contributes unsurpassed weatherability, abrasion-resistance, colorfastness, and resistance to dirt pick-up.

ADVANTAGES

Waterproofing: Features a flexible, 100%solids, moisture cure roof sealant used to reinforce seams, end laps, penetrations, and other flashing details.

Produces Aesthetic Finish: This highly-advanced coating system provides aged metal roof surfaces with a beautiful, low-build, architectural finish.

Custom Colors: The products that comprise this system are developed with superior color retention.

Low VOC: This system is a low VOC environmentally safe solution ideally suited for areas with strict environmental regulations.

Color Fade Warranty: This system includes a 10 year color fade warranty.

LIMITATIONS

Cost: This system costs more than other conventional metal roof coating systems.

Cold Weather: The products that comprise this system are water-based, so colder temperatures can delay the installation process.

Precipitation: To avoid material wash off, this system should not be applied if rain is expected.

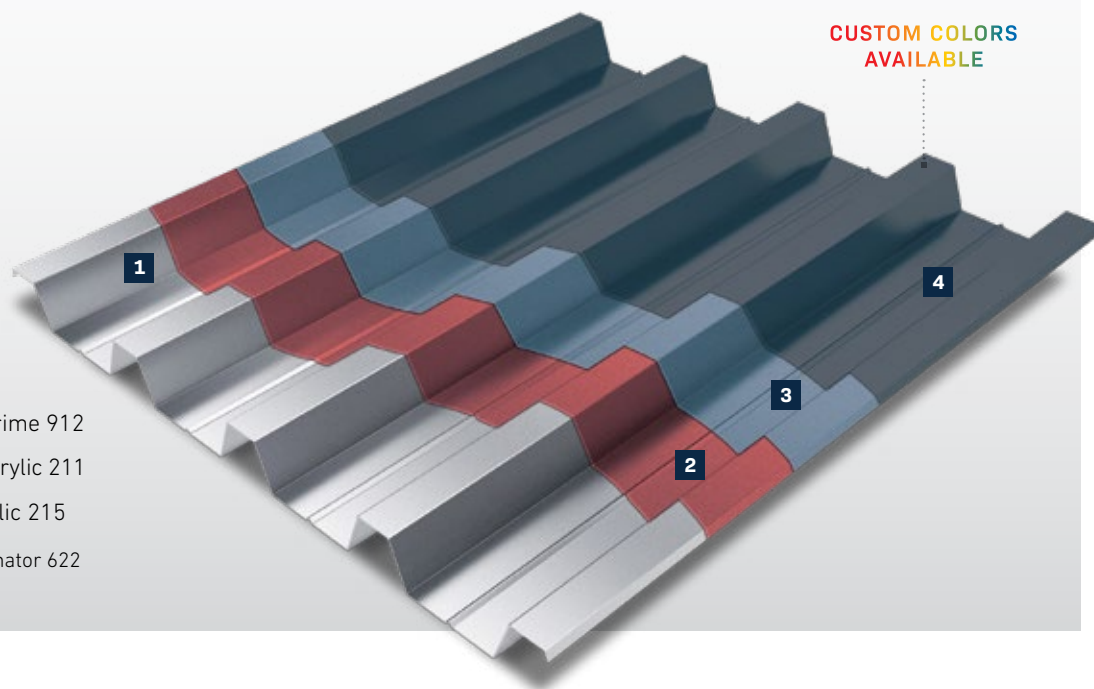

Wall-Coat™

ARCHITECTURAL COATING SYSTEM

SUITABLE SUBSTRATES

- Brick
- Concrete
- Masonry
- Stucco
- Wood

SYSTEM PRODUCTS

- Clear Prime 9000
- Acrylic Wall-Coat 2000
- Elastomeric Wall-Coat 2100

WARRANTY TERM LENGTH

- 5 year*
- 10 year*

**Material warranties only*

ARCHITECTURAL WALL COATING SYSTEM

The Wall-Coat Architectural Wall Coating System is the preferred solution to enhance, restore, and protect structural wall surfaces and facades. Engineered to provide durable, breathable, long-lasting protection, the Wall-Coat System is suited for both new construction and surface restoration/repair on a variety of surface types including brick, concrete, masonry, wood, and stucco.

ADVANTAGES

Breathability: This system provides a breathable watertight membrane that allows trapped moisture to escape.

Produces Aesthetic Finish: This highly-advanced coating system provides structural wall surfaces and facades with a beautiful, protective, long-lasting finish.

Low VOC: This system is a low VOC environmentally safe solution ideally suited for areas with strict environmental regulations.

LIMITATIONS

Cold Weather: The products that comprise this system are water-based, so colder temperatures can delay the installation process.

Precipitation: To avoid material wash off, this system should not be applied if rain is expected.

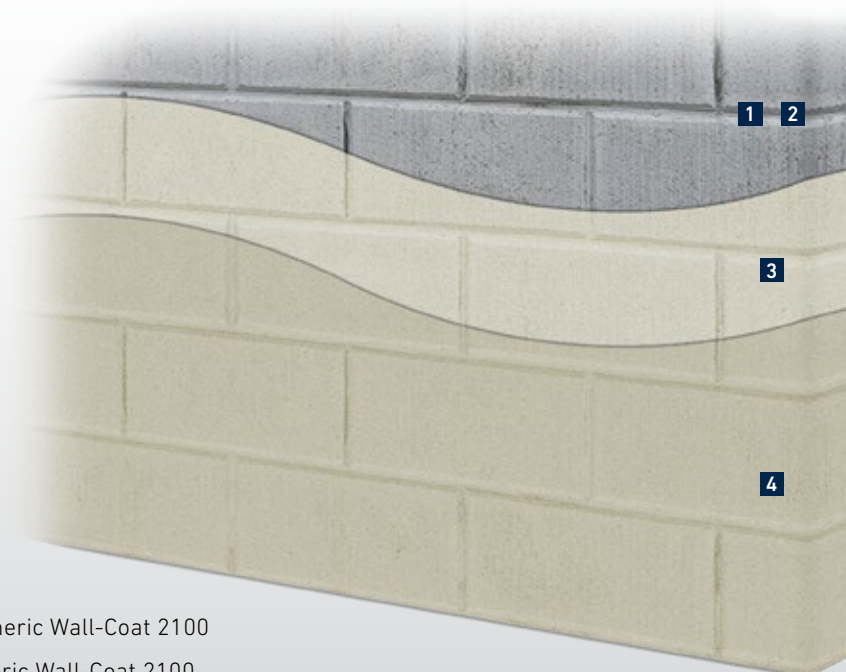

- 1 Existing Surface:** Concrete
- 2 Primer:** Clear Prime 9000
- 3 Base Coat:** Acrylic Wall-Coat 2000/Elastomeric Wall-Coat 2100
- 4 Top Coat:** Acrylic Wall-Coat 2000/Elastomeric Wall-Coat 2100

Wall-Coat^{DTM}

ARCHITECTURAL COATING SYSTEM

SUITABLE SUBSTRATES

- Metal

SYSTEM PRODUCTS

- Red Oxide Rust Prime 912
- DTM 3000

WARRANTY TERM LENGTH

- 5 year*
- 10 year*

**Material warranties only*

ARCHITECTURAL WALL COATING SYSTEM

The Wall-Coat DTM Architectural Wall Coating System is the preferred direct-to-metal solution to beautify, restore, and protect metal surfaces and facades. Its self-priming formula is engineered to provide an aesthetic, durable, and long-lasting finish and is suited for both new construction and metal surface restoration projects.

ADVANTAGES

Self Priming: This systems primary component, DTM 3000, eliminates the need for a bonding primer.

Produces Aesthetic Finish: This highly-advanced coating system provides structural wall surfaces and facades with a beautiful, protective, long-lasting finish.

Low VOC: This system is a low VOC environmentally safe solution ideally suited for areas with strict environmental regulations.

LIMITATIONS

Cold Weather: The products that comprise this system are water-based, so colder temperatures can delay the installation process.

Precipitation: To avoid material wash off, this system should not be applied if rain is expected.

CUSTOM COLORS AVAILABLE

- 1 Existing Surface: Metal
- 2 Primer: Red Oxide Rust Prime 912
- 3 Base Coat: DTM 3000
- 4 Top Coat: DTM 3000

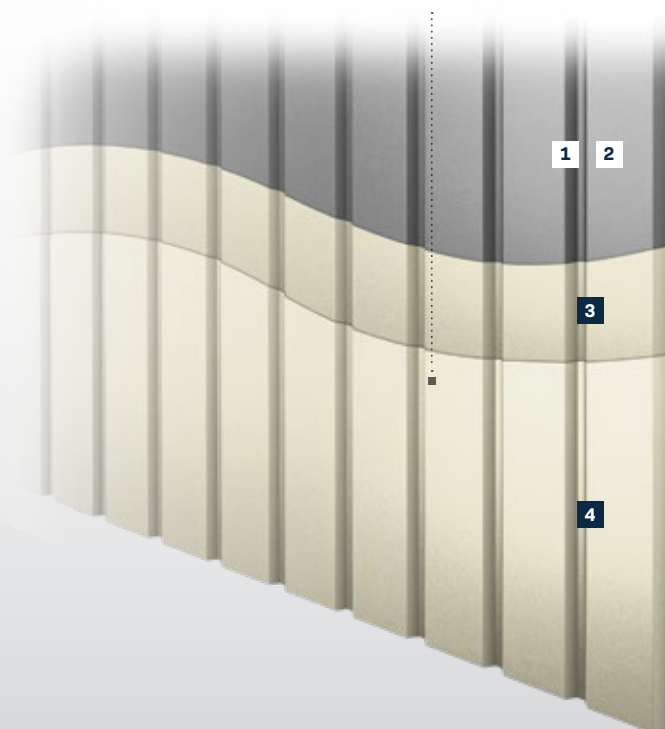

PROTECT YOUR INVESTMENT

With American WeatherStar's StarGard Warranty Program, commercial building owners can expect long-term protection and peace of mind. We provide a variety of long-term warranty alternatives when qualified systems are installed by an American WeatherStar Approved Contractor.



StarGard Warranty Program	GOOD	BETTER	BEST
	ROOF COATING MATERIAL	NDL SYSTEM	NDL SYSTEM ELITE
What's covered?	Material defects	Leaks caused by material defects & workmanship errors	Leaks caused by material defects & workmanship errors
Warranty fee?	No	Yes	Yes
Covers entire system?	Yes	Yes	Yes
No dollar limit for covered repairs?	Yes (material only)	Yes	Yes
Max term length?	20 years (material only)	Up to 15 years (depending on system)	20 years (labor & material)
Includes cost of material to correct problem?	Yes	Yes	Yes
Includes cost of labor to correct problem?	No	Yes	Yes
Requires annual inspection?	No	No	Yes
Recommended annual inspection?	Yes	Yes	Yes
Recommended semi-annual maintenance?	Yes	Yes	Yes
Requires document maintenance?	No	No	Yes
Who can offer warranty?	American WeatherStar Approved Contractor	American WeatherStar Approved Contractor	American WeatherStar Approved Contractor
StarGard+ Warranty Enhancements			
Is the warranty extendable?	Yes	Yes	No
Is the warranty renewable?	Yes	Yes	Yes
Is the warranty transferable?	Yes	Yes	Yes
*ALWAYS REVIEW WARRANTIES FOR COMPLETE COVERAGE AND RESTRICTIONS.			



II. ROOF COATINGS

ACRYLIC 211

Application Equipment: AIRLESS SPRAYER TANK SPREADER



TECHNICAL DATA

Solids by Volume:	55% \pm 2
Elongation:	233% \pm 20
Tensile Strength:	273 psi \pm 20
Shelf Life:	24 months

**See application guidelines for coverage rate details*

DESCRIPTION

Acrylic 211 is an elastomeric acrylic coating that combines high-solids emulsion polymers with potent biocides to provide excellent durability, reflectivity, weatherproofing, and mildew resistance.

FEATURES/BENEFITS

- Highly reflective—reflects 80-90% of UV radiation
- Contains strong mildewcides/fungicides
- Increased tensile strength and elongation at lower temperatures
- Excellent adhesion to various substrates
- Easy to use, easy to clean
- Economical

BASIC USES

Acrylic 211 is ideal for use as a protective and reflective membrane for a variety of roof substrates including metal, spray polyurethane foam, concrete, smooth BUR, modified bitumen, EPDM, and single-ply membranes.

SIZES/PACKAGING

5-gallon (19 liter) pail, 55-gallon (208 liters) drum

COLOR OPTIONS

White, gray, tan

HIGH-TENSILE ACRYLIC 211

Application Equipment: AIRLESS SPRAYER TANK SPREADER



TECHNICAL DATA

Solids by Volume:	55% ± 2
Elongation:	600% ± 50
Tensile Strength:	500 psi ± 50
Shelf Life:	24 months(40°F-90°F)

*See application guidelines for coverage rate details

DESCRIPTION

High Tensile Acrylic 211 is a technologically-advanced, high-solids, acrylic elastomeric coating uniquely formulated with high tensile strength and elongation properties.

FEATURES/BENEFITS

- Permits uniform, high-build coverage
- Reflects 80-90% of UV radiation
- Excellent color retention—ideal for custom tint projects
- Contains strong mildewcides/fungicides
- Excellent adhesion to various substrates
- Easy to use, easy to clean

BASIC USES

High-Tensile Acrylic 211 is ideal for use as a protective and reflective coating for a variety of roof substrates including metal, spray polyurethane foam, concrete, smooth BUR, modified bitumen, EPDM, and single-ply membranes.

SIZES/PACKAGING

5-gallon (19 liter) pail, 55-gallon (208 liters) drum

COLOR OPTIONS

White, gray, tan, premium, and custom colors available

HIGH-BUILD ACRYLIC 212

Application Equipment: AIRLESS SPRAYER TANK SPREADER



TECHNICAL DATA

Solids by Volume:	55 ± 2%
Elongation:	220 ± 20%
Tensile Strength:	300 ± 30 PSI
Shelf Life:	24 months

*See application guidelines for coverage rate details

DESCRIPTION

Based on our high-tensile formula, High-Build Acrylic 212 can be applied up to 50 wet mils in one coat. It is formulated utilizing specialized pigments and biocides to provide maximum UV resistance and minimize discoloration from dirt accumulation.

FEATURES/BENEFITS

- Can be applied up to 50 wet mils in one coat
- Sag resistant technology allows 50 mils to hang even on vertical surfaces
- Versatile—may be spray applied rolled or brushed
- Excellent adhesion to various substrates
- Industry leading tensile and elongation properties contribute to an extremely durable and long-lasting membrane with exceptional resistance to weathering
- Unique ability to “breathe,” providing a completely watertight membrane while also allowing trapped moisture to escape

BASIC USES

High-Build Acrylic 212 is designed as a protective membrane for most roofing surfaces including galvanized metal, concrete, PVC, Hypalon, EPDM, polyurethane foam and primed smooth and granulated asphaltic surfaces.

SIZES/PACKAGING

5-gallon (19 liter) pail, 55-gallon (208 liters) drum

COLOR OPTIONS

White, gray, tan, premium, and custom colors available

HIGH-GLOSS ACRYLIC 215

Application Equipment: AIRLESS SPRAYER



TECHNICAL DATA

Solids by Volume:	40% ± 2
Elongation:	300% ± 50
Tensile Strength:	1000 psi ± 50
Shelf Life:	24 months

*See application guidelines for coverage rate details

DESCRIPTION

High-Gloss Acrylic 215 is a single-component, water-based, flexible PVDC coating for spray application. It forms a low-build protective coating that provides excellent weatherability, abrasion resistance, color fastness, and resistance to dirt pick-up.

FEATURES/BENEFITS

- Excellent reflective properties
- Higher solids content
- Exceptional dirt, crack, and biological growth resistance
- Extremely smooth and continuously firm
- Ultra low VOC content
- Superior plasticizer migration and bleed resistance

BASIC USES

High-Gloss Acrylic 215 is a thin film coating designed to be applied over both primed and unprimed substrates. It should be utilized wherever long-term durability, dirt resistance, and color fastness is critical. It may be applied over these substrates with the use of an acrylic base coat: spray foam, TPO, PVC, EPDM, and asphaltic products such as BUR and modified bitumen.

SIZES/PACKAGING

5-gallon (19 liter) pail, 55-gallon (208 liters) drum

COLOR OPTIONS

White, gray, tan, premium, and custom colors available

ACRYLIC SKYLIGHT SEALER 230

Application Equipment: AIRLESS SPRAYER NAP ROLLER



*See application guidelines for coverage rate details

DESCRIPTION

Acrylic Skylight Sealer 230 is a translucent, elastomeric coating used to treat fiberglass skylight panels. This product provides a durable and weather-resistant finish that helps the panel maintain its translucent properties.

FEATURES/BENEFITS

- Extremely tough, durable, UV resistant sealant
- Excellent water resistance
- Superior bridging qualities over small cracks and openings
- Outstanding resistance to dirt collection and pollutants
- Environmentally safe

BASIC USES

Acrylic Skylight Sealer 230 is used with the American WeatherStar metal roof coating systems to help seal and recondition fiberglass skylight panels.

Note: if the skylights panels are cracked, Acrylic Skylight Sealer 230 is not a sufficient solution and the skylight panel should be replaced.

SIZES/PACKAGING

5-gallon (19 liter) pail

COLOR OPTIONS

Clear

BUTYL 310

Application Equipment: AIRLESS SPRAYER TANK SPREADER



TECHNICAL DATA

Solids by Volume:	40%
Elongation:	900% ± 100
Tensile Strength:	1000 psi ± 100
Shelf Life:	12 months

*See application guidelines for coverage rate details

DESCRIPTION

Butyl 310 is a butyl rubber, elastomeric, vapor-retardant coating designed to provide excellent UV protection and resistance to moisture penetration. Once cured, this polymer forms a durable, seamless, flexible, waterproof membrane that resists cracking and allows for thermal shock (normal expansion and contraction) of the roof structure.

FEATURES/BENEFITS

- Excellent vapor retardant barrier
- Highly reflective—reflects 80-90% of UV radiation
- Extremely high tensile strength and elongation
- Very flexible and durable
- Fast drying

BASIC USES

Butyl 310 is recommended as a protective vapor barrier coating for a variety of substrates including metal, modified bitumen, smooth BUR, single-ply, and spray polyurethane foam. It also contains a strong rust inhibitor—eliminating the need for a primer coat over mildly rusted metal surfaces.

SIZES/PACKAGING

5-gallon (19 liter) pail, 55-gallon (208 liters) drum

COLOR OPTIONS

White, gray, tan, premium, and custom colors available

SILICONE 410

Application Equipment: AIRLESS SPRAYER TANK SPREADER



TECHNICAL DATA

Solids by Volume:	69% ± 2
Elongation:	318%
Tensile Strength:	500 psi
Shelf Life:	12 months

*See application guidelines for coverage rate details

DESCRIPTION

Silicone 410 is a single component, solvent-borne, moisture-cure silicone roof coating designed to form a seamless, protective, weather-resistant membrane capable of withstanding ponding water and providing excellent UV protection.

FEATURES/BENEFITS

- Highly reflective—reflects 80-90% of UV radiation
- Capable of withstanding ponding water
- Excellent UV protection
- Highly flexible and durable
- Superior adhesive and cohesive strength
- High solids content

BASIC USES

Silicone 410 is ideal for use as a protective and reflective coating for a variety of different roof substrates including metal, spray polyurethane foam, smooth BUR, modified bitumen, EPDM, and single-ply membranes.

SIZES/PACKAGING

5-gallon (19 liter) pails, 50-gallon (208 liters) drums

COLOR OPTIONS

White, gray, tan, premium, and custom colors available

HIGH-SOLIDS SILICONE 412

Application Equipment: AIRLESS SPRAYER TANK SPREADER



DESCRIPTION

High-Solids Silicone 412 is a high solids, single component, moisture-cure, 100% silicone roof coating designed to provide a seamless, flexible, protective, and weather-resistant membrane capable of withstanding ponding water and providing excellent UV protection.

FEATURES/BENEFITS

- Highly reflective—reflects 80-90% of UV radiation
- Capable of withstanding ponding water
- Excellent UV protection
- Highly flexible and durable
- Superior adhesive and cohesive strength
- High-solids content

BASIC USES

High-Solids Silicone 412 is ideal for use as a protective and reflective coating for a variety of roof substrates including metal, spray polyurethane foam, smooth BUR, modified bitumen, EPDM, and single-ply membranes.

SIZES/PACKAGING

5-gallon (19 liter) pails, 50-gallon (208 liters) drums

COLOR OPTIONS

White, gray, tan, premium, and custom colors available

TECHNICAL DATA

Solids by Volume:	96% ± 2
Elongation:	170% ± 25
Tensile Strength:	450 psi ± 50
Shelf Life:	12 months

*See application guidelines for coverage rate details

ALIPHATIC URETHANE 510

Application Equipment: AIRLESS SPRAYER TANK SPREADER



DESCRIPTION

Aliphatic Urethane 510 is a technologically advanced, high solids, single component, moisture-cure polyurethane elastomeric roof coating designed to provide a durable, seamless, flexible, and waterproof membrane that resists lateral movement, shear, and will allow for natural expansion and contraction.

FEATURES/BENEFITS

- Highly reflective—reflects 80-90% of UV radiation
- Excellent UV protection
- Extremely durable and flexible
- Superior adhesive and cohesive strength
- Excellent adhesion to various roof substrates
- Resistant to dirt pick-up

BASIC USES

Aliphatic Urethane 510 was specifically developed as a bright white protective top coat for a variety of roof substrates including spray polyurethane foam, metal, modified bitumen, smooth BUR, and single-ply membranes.

SIZES/PACKAGING

5-gallon (19 liter) pails, 55-gallon (208 liters) drums

COLOR OPTIONS

White

TECHNICAL DATA

Solids by Volume:	74%
Elongation:	350% ± 50
Tensile Strength:	1100 psi ± 25
Shelf Life:	90 days

*See application guidelines for coverage rate details

AROMATIC URETHANE 520

Application Equipment: AIRLESS SPRAYER TANK SPREADER

TECHNICAL DATA

Solids by Volume:	70% ± 2
Elongation:	350% ± 50
Tensile Strength:	975 psi ± 25
Shelf Life:	6 months

*See application guidelines for coverage rate details

DESCRIPTION

Aromatic Urethane 520 is a high-solids, single-component, moisture-cure polyurethane elastomeric coating designed to provide a durable, seamless, flexible, waterproof membrane that resists lateral movement, shear and will allow for natural expansion and contraction.

FEATURES/BENEFITS

- Highly reflective
- Extremely durable and flexible
- Superior adhesive and cohesive strength
- Excellent adhesion to various roof substrates
- Resistant to dirt pick-up

BASIC USES

Aromatic Urethane 520 was developed as a durable, protective foundation coating for a variety of roof substrates including spray polyurethane foam, metal, modified bitumen, smooth BUR, single-ply, and concrete.

SIZES/PACKAGING

5-gallon (19 liter) pails, 55-gallon (208 liters) drums

COLOR OPTIONS

Metallic Gray



III. ROOF MASTICS

ACRYLIC BRUSH-GRADE 220

Application Equipment:

AIRLESS SPRAYER

CHIP BRUSH

BULK GUN



TECHNICAL DATA

Solids by Volume: 55% \pm 3

Elongation: 315%

Tensile Strength: 500 psi

Shelf Life: 24 months

**See application guidelines for coverage rate details*

DESCRIPTION

Acrylic Brush-Grade 220 is a water-based, high solids, elastomeric sealant manufactured from a unique acrylic resin and designed to increase tensile strength and elongation.

FEATURES/BENEFITS

- **New spray-grade formulation**
- Forms a durable, flexible, weather-resistant seal
- Plasticizer-free caulk—will not dry out or become brittle
- Superior tensile strength and elongation
- Excellent adhesive and cohesive strength
- Easy to use, easy to clean

BASIC USES

Acrylic Brush-Grade 220 is suited for sealing mechanical fasteners and vertical seams on metal roofs, as well as around flashings, drains, and penetrations on most roof surfaces including modified bitumen, metal, smooth BUR, concrete, wood, spray polyurethane foam, and single-ply.

SIZES/PACKAGING

5-gallon (19 liter) pail

COLOR OPTIONS

White

ACRYLIC BUTTER-GRADE 221

Application Equipment:

CHIP BRUSH

BULK GUN



TECHNICAL DATA

Solids by Volume: 66% ± 2

Elongation: 200%

Tensile Strength: 325 psi

Shelf Life: 24 months

**See application guidelines for coverage rate details*

DESCRIPTION

Acrylic Butter-Grade 221 is a water-based, high solids, elastomeric sealant manufactured from a unique acrylic resin and designed to increase tensile strength and elongation.

FEATURES/BENEFITS

- Light-bodied acrylic mastic
- Forms a durable, flexible, weather-resistant seal
- Plasticizer-free caulk—will not dry out or become brittle
- Superior tensile strength and elongation
- Excellent adhesive and cohesive strength
- Easy to use, easy to clean

BASIC USES

Acrylic Brush-Grade 221 is suited for sealing mechanical fasteners and vertical seams on metal roofs, as well as around flashings, drains, and penetrations on most roof surfaces including modified bitumen, metal, smooth BUR, concrete, wood, spray polyurethane foam, and single-ply.

SIZES/PACKAGING

5-gallon (19 liter) pail

COLOR OPTIONS

White, gray

ACRYLIC FLASHING-GRADE 222

Application Equipment:

CHIP BRUSH

BULK GUN



TECHNICAL DATA

Solids by Volume: 64% ± 2

Elongation: 500%

Tensile Strength: 100 psi ± 25

Shelf Life: 24 months

**See application guidelines for coverage rate details*

DESCRIPTION

Acrylic Flashing-Grade 222 is a 100% acrylic, high solids, elastomeric sealant utilizing the latest advances in acrylic technology. It is manufactured from a unique acrylic resin designed to increase tensile strength and elongation.

FEATURES/BENEFITS

- Heavy-bodied acrylic mastic
- Increased tensile strength and elongation
- Forms a durable, flexible, weather-resistant seal
- Plasticizer-free caulk—will not dry out or become brittle
- Superior adhesive and cohesive strength
- Easy to use, easy to clean

BASIC USES

Acrylic Flashing-Grade 222 is ideally suited for sealing mechanical fasteners and vertical seams on metal roofs, as well as around flashings, drains, and penetrations on most roof surfaces including modified bitumen, metal, smooth BUR, concrete, wood, spray polyurethane foam, and single-ply.

SIZES/PACKAGING

5-gallon (19 liter) pail

COLOR OPTIONS

White

BUTYL BRUSH-GRADE 320

Application Equipment:

CHIP BRUSH

BULK GUN



TECHNICAL DATA

Solids by Volume:	40% ± 2
Elongation:	500% ± 50
Tensile Strength:	500 psi ± 50
Shelf Life:	12 months

*See application guidelines for coverage rate details

DESCRIPTION

Butyl Brush-Grade 320 is a single component, vapor retardant, butyl seam sealer formulated to provide superior permeability and UV protection. It offers excellent elongation and tensile strength to resist lateral movement and allow for thermal shock (normal expansion and contraction) of the roof structure.

FEATURES/BENEFITS

- Excellent vapor retardant mastic
- Extremely high tensile strength and elongation
- Superior permeability and UV protection
- Highly flexible, durable, and fast drying

BASIC USES

Butyl Brush-Grade 320 is recommended as a protective, vapor-retardant, seam-sealer for a variety of situations, including all types of seams, fasteners, gaps between metal panels, gutters, vent pipe flashings, air conditioning units and expansion joints. It is ideal for use on a variety of roof substrates including spray polyurethane foam, metal, modified bitumen, single-ply, and smooth BUR.

SIZES/PACKAGING

5-gallon (19 liter) pail

COLOR OPTIONS

White

SILICONE BRUSH-GRADE 422

Application Equipment:

CHIP BRUSH

BULK GUN



TECHNICAL DATA

Solids by Volume:	96% ± 3
Elongation:	275%
Tensile Strength:	130 psi
Shelf Life:	12 months(40°F-90°F)

*See application guidelines for coverage rate details

DESCRIPTION

Silicone Brush-Grade 422 is a ready-to-use, high solids, single component, moisture-cure, 100% silicone mastic designed to waterproof and protect penetrations, curbs, seams, and flashings areas.

FEATURES/BENEFITS

- Outstanding UV stability
- Capable of withstanding ponding water
- Highly flexible and durable
- Superior adhesion to silicone coated surfaces
- 95% solids—uses less material for same dry film thickness
- Low VOC (volatile organic compounds)

BASIC USES

Silicone Brush-Grade 422 is recommended for waterproofing penetrations, curbs, seams, and flashings areas on a variety of roof substrates including modified bitumen, metal, single-ply, smooth BUR, spray polyurethane foam, and previously coated silicone areas.

SIZES/PACKAGING:

2-gallon (7.5 liter) pail, 5-gallon (19 liter) pail

COLOR OPTIONS

White

URETHANE BRUSH-GRADE 522

Application Equipment: CHIP BRUSH BULK GUN 



TECHNICAL DATA	
Solids by Volume:	69% ± 2
Elongation:	350% ± 50
Tensile Strength:	975 psi ± 25
Shelf Life:	6 months

**See application guidelines for coverage rate details*

DESCRIPTION

Urethane Brush-Grade 522 is a high solids, single component, moisture-cure polyurethane elastomeric coating specifically formulated with higher viscosity to waterproof and protect large gaps and problem areas.

FEATURES/BENEFITS

- Extremely durable and flexible
- Superior adhesive and cohesive strength
- Able to withstand ponding water
- Excellent adhesion to various roof substrates
- Resistant to dirt pick-up
- Fast drying

BASIC USES

Urethane Brush-Grade 522 provides excellent adhesion and may be used for protection of conventional roof surfaces including modified bitumen, EPDM, single-ply membranes, concrete, masonry, metal, and spray polyurethane foam.

SIZES/PACKAGING

5-gallon (19 liter) pail, 1-gallon (3.8 liter) pail, 20 oz. sausage tubes

COLOR OPTIONS

Metallic Gray



IV. TERMINATOR ROOF SEALANT

TERMINATOR 622

Application Equipment:

CHIP BRUSH

BULK GUN

CAULK GUN



TECHNICAL DATA

Solids by Volume: 100%

Elongation: 500%

Tensile Strength: 200 psi

Shelf Life: 12 months

**See application guidelines for coverage rate details*

DESCRIPTION

Terminator 622 is technologically advanced, 100% solids, moisture-cure sealants and adhesives. This high strength, versatile product has excellent elasticity and adhesion, making it ideal for repairs. It can even be applied to wet and underwater surfaces. It is also UV resistant and VOC compliant.

FEATURES/BENEFITS

- Specifically designed for seams, fasteners, ridge caps, flashings, and penetrations
- Compatible with acrylic, urethane, and silicone systems
- Performance at temperatures as low as -40° F
- Bonds to damp surfaces and is rain-tolerant during cure
- Cures to be a waterproof, tough, and flexible sealant
- Low odor and minimal shrinkage
- Non-staining and mildew resistant

BASIC USES

Terminator 622 is a brush-grade, self-leveling sealant used to reinforce seams, end laps, penetrations, and other details.

SIZES/PACKAGING

10 oz., 2-gallon (7.5 liter) pail

COLOR OPTIONS

White



V. PRIMERS & CLEANERS

ACRYLIC BONDING PRIMER 905

Application Equipment: AIRLESS SPRAYER NAP ROLLER



**See application guidelines for coverage rate details*

DESCRIPTION

Acrylic Bonding Primer 905 is a durable, water-based primer suitable for priming most roofing substrates to promote optimal adhesion.

FEATURES/BENEFITS

- Excellent adhesion to most roof surfaces
- Bonds to unstable substrates
- Provides a tough, adhesive, durable film
- Quick drying time
- Environmentally safe
- Easy to use, easy clean

BASIC USES

Acrylic Bonding Primer 905 promotes adhesion and is ideal for use with most American WeatherStar roof restoration systems. It is suitable for previously coated metal, modified bitumen, smooth BUR, and spray polyurethane foam.

SIZES/PACKAGING

5-gallon (19 liter) pail, 55-gallon (208 liters) drum

COLOR OPTIONS

Black, gray

RED OXIDE RUST PRIME 912

Application Equipment: AIRLESS SPRAYER NAP ROLLER



**See application guidelines for coverage rate details*

DESCRIPTION

Red Oxide Rust Prime 912 is a corrosion-resistant, acrylic primer specifically developed to adhere to moderate-to-heavy rusted metal roof surfaces through its ability to inhibit the oxidizing of the substrate.

FEATURES/BENEFITS

- Designed to inhibit rust on metal surfaces
- Excellent adhesion to rusty metal surfaces
- Provides a tough, adhesive, durable film
- Environmentally safe
- Easy to use, easy to clean
- VOC complaint

BASIC USES

Red Oxide Rust Prime 912 is designed to inhibit rust on metal roof surfaces and for use as an adhesion bonding primer before roof coatings are applied.

SIZES/PACKAGING

5-gallon (19 liter) pail, 55-gallon (208 liters) drum

COLOR OPTIONS

Red

COLOR PRIME 915

Application Equipment: AIRLESS SPRAYER NAP ROLLER



**See application guidelines for coverage rate details*

DESCRIPTION

Color Prime 915 is a high-quality, rust-inhibitive, water-based, low VOC primer. It provides an optimal surface for the application of fluoropolymer topcoats.

FEATURES/BENEFITS

- Resists heat, cold, moisture, and weathering
- Dries quickly
- Low VOC (Volatile Organic Compounds)
- Easy to use and clean

BASIC USES

Color Prime 915 is used as a priming coat over metal surfaces for the application of water-based fluoropolymer topcoats. Low VOC levels allow application in most environments with restrictive air quality. Fast drying and increases in roof surface temperature are provided by the product's ivory color.

SIZES/PACKAGING

5-gallon (19 liter) pail, 55-gallon (208 liters) drum

COLOR OPTIONS

Ivory

ECOCLEANER 925

Application Equipment: GARDEN SPRAYER



**See application guidelines for coverage rate details*

DESCRIPTION

EcoCleaner 925 is a unique and environmentally friendly cleaner. Its biodegradable formulation meets all US VOC regulations, including the most stringent Southern California regulations. It is a low foaming formulation that features significant renewable content with exceptional cleaning ability.

FEATURES/BENEFITS

- Environmentally friendly cleaner
- Biodegradable low-foaming formulation
- Meets all US VOC regulations
- Exceptional cleaning ability
- Significant renewable content

BASIC USES

This product is diluted 5:1 for effective cleaning of most surfaces including roofs, decks, concrete, and steel. EcoCleaner 925 may be used at lower dilutions for tougher stains and soiling. Old paints and adhesives may be removed with no, or minimal dilutions.

SIZES/PACKAGING

5-gallon (19 liter) pail

COLOR OPTIONS

Clear

FABRIC BOND 930

Application Equipment: AIRLESS SPRAYER NAP ROLLER CHIP BRUSH



**See application guidelines for coverage rate details*

DESCRIPTION

Fabric Bond 930 is a bonding agent that fully secures polyester fabric to a variety of roof surfaces.

FEATURES/BENEFITS

- Seals asphaltic surfaces with little or no bleed through
- Excellent adhesion to various surfaces
- VOC compliant
- Environmentally safe
- Easy to use, easy clean up

BASIC USES

Fabric Bond 930 is primarily used to fully secure polyester fabric to a variety of roof surfaces including asphalt, concrete, wood, tile, metal, and virtually any clean, dry, non-silicone surface.

SIZES/PACKAGING

5-gallon (19 liter) pail

COLOR OPTIONS

Blue

CLEAR PRIME 9000

Application Equipment: AIRLESS SPRAYER NAP ROLLER



**See application guidelines for coverage rate details*

DESCRIPTION

Clear Prime 9000 provides an excellent sealer for concrete or masonry surfaces. It will improve adhesion of coating systems and reduce excess usage of top coat materials, allowing them to remain on the surface for maximum protection.

FEATURES/BENEFITS

- Excellent sealer
- Reduces top coat absorption
- Low VOC
- Easy to use and clean

BASIC USES

Clear Prime 9000 is a rapid drying water-based technology compatible with most types of top coats. It saves money by reducing the absorption of top coats into the substrate. Clear Prime 9000 is low VOC technology that meets most VOC regulations and is easy to apply.

SIZES/PACKAGING

5-gallon (19 liter) pail

COLOR OPTIONS

Clear



VI. WALL COATINGS

ACRYLIC WALL COAT 2000

Application Equipment: AIRLESS SPRAYER NAP ROLLER



TECHNICAL DATA

Solids by Volume:	50 ± 2%
Elongation:	210% ± 20
Tensile Strength:	260 psi ± 20
Shelf Life:	12 months

*See application guidelines for coverage rate details

DESCRIPTION

Acrylic Wall Coat 2000 is a plasticizer-free, single-component, water-based, 100% acrylic elastomeric wall coating for spray, brush, or roller application. It has excellent tensile strength and elongation which form a durable and long lasting membrane with good resistance to weathering.

FEATURES/BENEFITS

- Excellent tensile and elongation
- Exceptional crack-bridging ability
- Superior UV resistance
- Resistant to dirt pickup
- Forms a watertight, breathable membrane

BASIC USES

Acrylic Wall Coat 2000 is designed to provide a good balance of weatherability, flexibility, and dirt resistance for protection of most surfaces, including masonry, wood, and metal. Please contact American WeatherStar technical services for primer recommendations.

SIZES/PACKAGING

5-gallon (19 liter) pail

COLOR OPTIONS

White, gray, tan, premium, and custom colors available

ELASTOMERIC WALL COAT 2100

Application Equipment: AIRLESS SPRAYER NAP ROLLER



TECHNICAL DATA

Solids by Volume:	50 ± 2%
Elongation:	600% ± 20
Tensile Strength:	500 psi ± 50
Shelf Life:	12 months

*See application guidelines for coverage rate details

DESCRIPTION

Elastomeric Wall Coat 2100 is a high-performance, plasticizer-free, single-component, water-based, 100% acrylic elastomeric wall coating for spray, brush, or roller application. It is an industry-leading product with high tensile strength and elongation to contribute to a durable, long-lasting membrane with good resistance to weathering.

FEATURES/BENEFITS

- Excellent tensile and elongation
- Exceptional crack-bridging ability
- Superior UV resistance
- Resistant to dirt pickup
- Forms a watertight, breathable membrane

BASIC USES

Elastomeric Wall Coat 2100 is designed to provide a good balance of flexibility and dirt resistance for protection of most surfaces, including masonry, wood, and galvanized metal. Check with your American WeatherStar representative for primer recommendations.

SIZES/PACKAGING

5-gallon (19 liter) pail

COLOR OPTIONS

White, gray, tan, premium, and custom colors available

DTM 3000

Application Equipment: AIRLESS SPRAYER NAP ROLLER



TECHNICAL DATA

Solids by Volume:	41 ± 3%
Shelf Life:	12 months

*See application guidelines for coverage rate details

DESCRIPTION

The Wall-Coat DTM Architectural Wall Coating System is the preferred direct-to-metal solution to beautify, restore, and protect metal surfaces and facades. Its self-priming formula is engineered to provide an aesthetic, durable, and long-lasting finish and is suited for both new construction and metal surface restoration projects.

FEATURES/BENEFITS

- Highest performance acrylic direct-to-metal enamel
- Exceptional corrosion resistance, hardness protection, & water resistance
- High gloss and gloss retention
- Outstanding ultraviolet light resistance
- Excellent adhesion
- Exceptional dirt resistance
- Resists heat, cold, moisture and weathering
- Quick drying

BASIC USES

DTM 3000 is used as a direct-to-metal coating over metal surfaces. The best application is restoring metal wall panels. Low VOC levels allow application in most air quality restrictive areas. This product is also fast drying for quicker return to service.

SIZES/PACKAGING

5-gallon (19 liter) pail



VII. ACCESSORIES

SILICONE WALK PATH 415

Application Equipment: NAP ROLLER



DESCRIPTION

Silicone Walk Path 415 is a single component, moisture-cure, silicone coating designed to enhance the impact resistance of the roof surface and provides a non-skid walking surface when used with Walk Path Granules 1100.

FEATURES/BENEFITS

- Provides highly visible route for pedestrian maintenance traffic
- Forms a durable non-slip surface when used with Walk Path Granules 1100
- Provides an extra layer of protection for high traffic areas

BASIC USES

Silicone Walk Path 415 is used with Walk Path Granules 1100 to build a protective walkway on roof surfaces including: modified bitumen, spray polyurethane foam, concrete, EPDM, and single-ply.

SIZES/PACKAGING

5-gallon (19 liter) pail

COLOR

Safety Yellow

TECHNICAL DATA

Solids by Volume: 95% ± 2

Elongation: 174%

Tensile Strength: 350 psi

Shelf Life: 12 months

WALK PATH GRANULES 1100



DESCRIPTION

Walk Path Granules 1100 are designed to enhance impact resistance of roof surfaces and provide a non-skid walking surface when embedded in Silicone Walk Path 415.

BASIC USES

Walk Path Granules 1100 are used in conjunction with Silicone Walk Path 415 to build a protective walkway on roof surfaces including: modified bitumen, spray polyurethane foam, concrete, EPDM, and other single-ply materials.

SIZES/PACKAGING

2-gallon (7.5 liter) pail

COLOR OPTIONS

Safety Yellow

POLYESTER FABRIC



DESCRIPTION

Polyester Fabric is a spun-laced textile material composed of staple fibers hydraulically entangled to form a strong reinforcing membrane for cold roofing mastics. Composed of 100% polyester, this product has excellent conformability and elongation. The open aperture design allows coatings to flow through and form a saturated layer rather than a laminated roofing membrane.

FEATURES/BENEFITS

- Lightweight non-raveling fabric with excellent tear strength
- Excellent elongation and tensile strength
- Maintains physical properties when wet
- Resistant to chemicals and solvents

BASIC USES

Polyester Fabric is used with a variety of cold process roof coatings, including cutback asphalt, asphalt emulsion, elastomeric asphalt and acrylic coatings. Embed the fabric with a coating and cover as per coating manufacturer's directions.

SIZES/PACKAGING

2" x 100', 4" x 360', 6" x 360', 12" x 360', 20" x 360', 36" x 360'

BUTYL SEAM TAPE

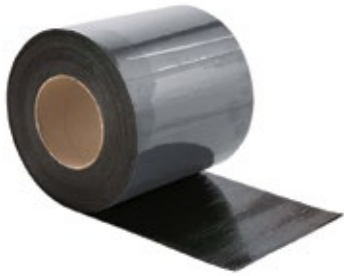

DESCRIPTION

Butyl Seam Tape is a pressure-sensitive seam sealing tape with Dupont Sontara® Fabric backing bonded onto 20 mils of butyl rubber adhesive.

FEATURES/BENEFITS

- Lightweight
- High tensile strength
- Maintains physical properties when wet
- Extremely flexible—allows for expansion and contraction

BASIC USES

Seam tape is recommended for sealing seams and penetrations on EPDM, TPO, and PVC commercial roofs. Seam tape can take the place of the non-woven Polyester Fabric and offer greater strength.

SIZES/PACKAGING

3"x50', 4"x50', 6"x50'

MICRO FIBERS 1000



DESCRIPTION

Micro-Fibers 1000 is a micro-fine, high-tensile polyethylene fiber used as a general thickener for acrylic, butyl, silicone, and urethane coatings products.

FEATURES/BENEFITS

- Economical
- Mixes easily to increase viscosity and tensile strength
- Retains elastic properties
- Will not decompose

BASIC USES

Micro-Fibers 1000 can be used to thicken acrylic, butyl, silicone, and urethane coatings into brushable mastics.

SIZES/PACKAGING

5 lb. box

XYLENE & MINERAL SPIRITS



DESCRIPTION

Xylene and mineral spirits are essential when installing solvent-based coatings. Unlike most solvents on the market, these are not recycled. It is critical to use pure solvents when cleaning to avoid expensive repairs to equipment.

BASIC USES

- Xylene is used with urethane and butyl coatings
- Mineral spirits are used with silicone coatings



SIZES/PACKAGING

5-gallon (19 liter) pail

COATINGS COLOR CHART

STANDARD COLORS

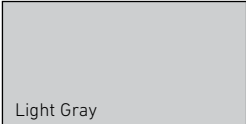
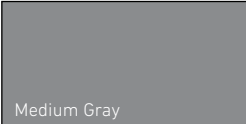
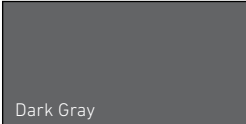
No additional charge for standard colors. Minimum 5 gallon order.

 White	 Light Gray	 Medium Gray	 Dark Gray	 Tan
---	--	---	--	---

PREMIUM COLORS

\$8 per gallon charge for premium colors. Minimum 200 gallon order.













 Federal Brown (6083)	 Brick Red (6328)	 Terracotta (2803)	 Safety Yellow (6907)	 Olive Green (6402)
 Forest Green (6461)	 Light Blue (6507)	 Dark Blue (6510)		

Custom Colors Available

QUOTE REQUIRED FOR CUSTOM COLORS

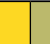
Costs may vary depending on color. Minimum 200 gallon order. See chart below for product availability.

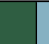
- All colors shown are representation only. Due to screen variations, ink, or other factors, colors shown may be a different than the actual product or sample color sheet.
- All products will be made to the best of our ability to provide uniformity compliant with coating industry standards. For color verification, a color sample is available upon request.
- Standard color options may vary depending on product chemistry. If different product chemistries are required for a project, please request sample for color verification.
- Color may be affected by application technique, surface texture, and lighting conditions when product is applied. Premium/custom color coatings are prone to fade over time.
- White is the only color stocked and ready for shipment upon order being placed. Please allow 7-10 business days for manufacturing of all other color options.
- Premium/custom colors are manufactured with the understanding that the customer agrees to purchase up to an additional 10% of product that may occur during manufacturing process.

Product Color Availability	Standard					Premium								Custom
														
Acrylic 211	■	■		■	■									
High-Tensile Acrylic 211	■	■		■	■	■	■	■	■	■	■	■	■	■
High-Build Acrylic 212	■	■		■	■	■	■	■	■	■	■	■	■	■
High-Gloss Acrylic 215*	■	■		■	■	■	■	■	■	■	■	■	■	■
Butyl 310	■	■	■		■									
Silicone 410	■	■	■	■	■	■	■	■	■	■	■	■	■	■
High-Solids Silicone 412	■	■	■	■	■	■	■	■	■	■	■	■	■	■
Aliphatic Urethane 510	■													
Wall Coatings	■					■	■	■	■	■	■	■	■	■

*45 GALLON MINIMUM ORDER

SYSTEM APPROVALS

System	Substrate	FM	UL	Miami-Dade	Flor. Product	Energy Star	CRRC	NSF
Ure-A-Sil	BUR	■				■	■	■
	Concrete					■	■	■
	EPDM	■		■	■	■	■	■
	Mod bit	■		■	■	■	■	■
	TPO, PVC	■				■	■	■
	SPF (Recoat)					■	■	■
Envir-O-Sil	BUR	■				■	■	■
	Concrete					■	■	■
	EPDM	■				■	■	■
	Mod bit	■		■	■	■	■	■
	PVC	■	■	■	■	■	■	■
	SPF (Recoat)					■	■	■
	TPO	■				■	■	■
Met-A-Gard	Metal	■	■	■	■	■	■	
Met-A-Gard+	Metal					■	■	
Met-A-Sil	Metal	■		■	■	■	■	■
System	Material	FM	UL	Miami-Dade	Flor. Product	Energy Star	CRRC	NSF
Foam-Gard (All substrates)	Acrylic 211		■	■	■	■	■	
	High-Tensile Acrylic 211					■	■	
	Silicone 410	■	■	■	■	■	■	■
	High-Solids Silicone 412		■			■	■	■
	Aliphatic Urethane 510					■	■	
	Aromatic Urethane 520							

PRODUCT APPROVALS

Product	Substrate	FM	UL	Miami-Dade	Flor. Product	Energy Star	CRRC	NSF
Acrylic 211	BUR	■	■			■	■	
	Concrete			■	■	■	■	
	EPDM		■	■	■	■	■	
	Metal	■	■	■	■	■	■	
	Mod bit		■	■	■	■	■	
	Single-ply					■	■	
	SPF		■	■	■	■	■	
High-Tensile Acrylic 211	BUR					■	■	
	Concrete					■	■	
	EPDM					■	■	
	Metal					■	■	
	Mod bit					■	■	
	Single-ply					■	■	
	SPF					■	■	
Butyl 310	BUR					■	■	
	Metal					■	■	
	Mod bit					■	■	
	Single-ply					■	■	
Silicone 410	BUR					■	■	■
	Concrete					■	■	■
	EPDM			■	■	■	■	■
	Metal			■	■	■	■	■
	Mod bit			■	■	■	■	■
	Single-ply		■			■	■	■
	SPF	■	■	■	■	■	■	■
High-Solids Silicone 412	BUR	■				■	■	■
	Concrete					■	■	■
	EPDM	■				■	■	■
	Metal	■		■	■	■	■	■
	Mod bit	■		■	■	■	■	■
	PVC, TPO	■	■	■	■	■	■	■
	SPF		■			■	■	■
Aliphatic Urethane 510	Concrete			■	■	■	■	
	Mod bit			■	■	■	■	
	SPF					■	■	
Aromatic Urethane 520	BUR	■		■	■			
	Concrete			■	■			
	EPDM	■		■	■			
	Mod bit	■		■	■			
	PVC, TPO	■						

2-DAY ROOF COATINGS TRAINING COURSE FOR COMMERCIAL ROOFING PROS

FASTACADEMY[®]



MULTIMEDIA PRESENTATIONS



HANDS-ON DEMOS



NETWORKING OPPORTUNITIES



CONTRACTOR Q&A

CONTRACTORS - CONSULTANTS - ARCHITECTS - ESTIMATORS - DISTRIBUTORS

GIVE YOUR ROOFING BUSINESS AN EDGE

Looking to give your commercial roofing business an edge and land the break-through jobs you really want? Not sure how to do it? Diversifying your business with FAST Academy (Fluid-Applied System Techniques) is the answer!

- Comprehensive overviews of roof coating systems and products
- Insightful and informative multimedia presentations
- Live application of American WeatherStar's Ure-A-Sil[®] System
- Hands-on demonstrations with the latest coatings technology and equipment
- Q&A sessions with American WeatherStar Platinum Elite Contractors
- Insights into proven sales practices and techniques
- Networking opportunities with industry pros from across the country

WANT TO ATTEND FAST?

For more information on upcoming FAST courses, visit www.americanweatherstar.com/fast or call us at 800-771-6643.



HEADQUARTERS

8095 Padgett Switch Rd.
Irvington, AL 36544
Toll Free: 800.771.6643
Office: 251.476.7385

WAREHOUSE LOCATIONS

Mobile, Alabama
Atlanta, Georgia
Dallas, Texas
San Juan, Puerto Rico

CONNECT WITH US



www.americanweatherstar.com